

# For Lease

800 Aerospace Boulevard

SLEMON PARK, PRINCE EDWARD ISLAND, CANADA



ENHANCE YOUR BUSINESS POTENTIAL IN PRINCE EDWARD ISLAND.



This property is located in the north end of Slemon Park, close to the famous Malpeque Bay and the majority of Slemon Park's aerospace tenants. It is a large multi-use and multi-tenant hangar of approximately 300,000 square feet.

This building features direct access to the Summerside Airport taxiway as well as significant aprons and plane storage areas, including "run up" areas for aircraft. The hangar is ideal for deep maintenance, component repair, and general manufacturing.

# Photos

800 AEROSPACE BLVD | SLEMON PARK, PRINCE EDWARD ISLAND, CANADA

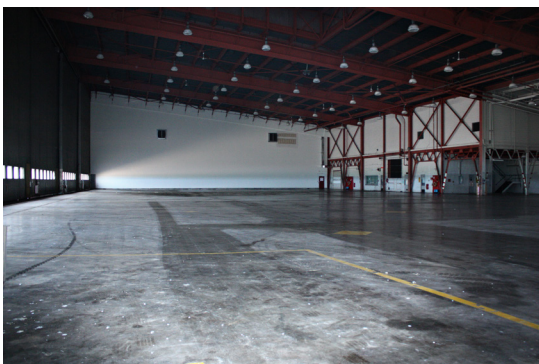

# Building Layout

800 AEROSPACE BLVD | SLEMON PARK, PRINCE EDWARD ISLAND, CANADA



## SECOND FLOOR

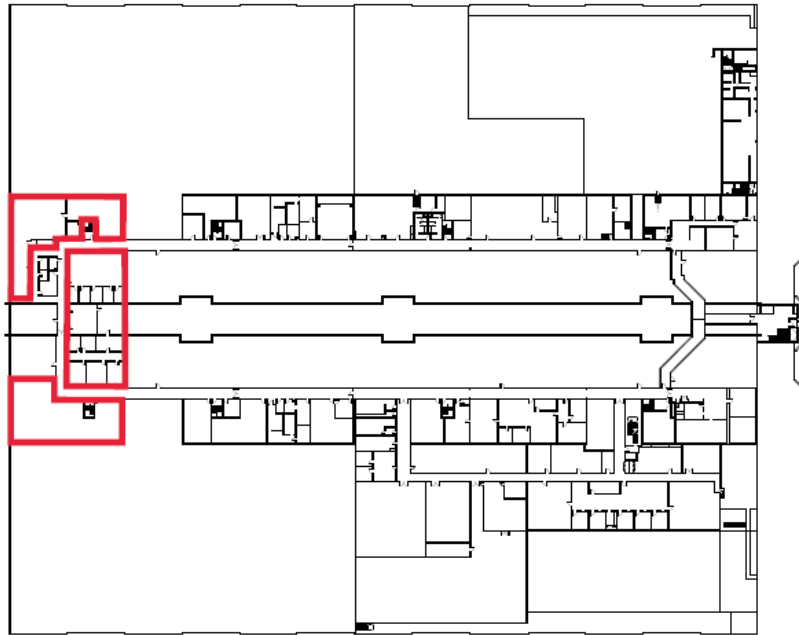

10,000 sq. ft.

The red areas denote space available for lease.

## Features

- Approximately 10,000 sq. ft. of available office/storage space on 2nd floor
- Elevator Access
- Ample Parking
- 3 Phase power, 400 amp/600 volt
- Oil heat
- High speed fiber available
- Sprinkler system

# Location

800 AEROSPACE BLVD | SLEMON PARK, PRINCE EDWARD ISLAND, CANADA



Located on the East Coast of Canada, Slemon Park is easily accessible from major highways and is less than 7 minutes from the City of Summerside, less than an hour from the capital city of Charlottetown as well as just 30 minutes from the Confederation Bridge. Slemon Park is the focal point of Prince Edward Island's globally competitive manufacturing

and aerospace industries and is regarded as a well-established training hub. Slemon Park is a thriving community with access to an on-site residential community, hotel, conference centre, food services and private airport. These commercial, residential, hospitality and lifestyle amenities combine to make Slemon Park an easy and convenient place to do business.

**Shawn McCarvill**  
President

**Tel:** 902-432-1704  
**Cell:** 902-439-0841

[smccarvill@slemonpark.com](mailto:smccarvill@slemonpark.com)  
[www.slemonpark.com](http://www.slemonpark.com)